

EE 42 x 15

Ferrite E Cores to Din 21295 EE 42 x 15 Hitachi SB7C material

Data sheet Ref: APS-7 (12/04/02)

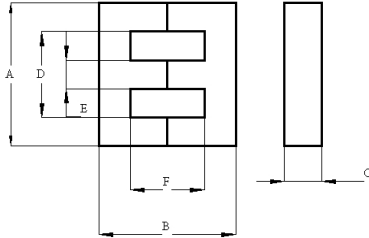

Magnetic Data for a pair of cores

Parameter	symbol	value
Effective magnetic path length	L_e	97.0mm
Effective area of magnetic path	A_e	182.0mm ²
Effective magnetic volume	V_e	17600mm ³
$\sum \mu_A$	CL	0.534mm ⁻¹

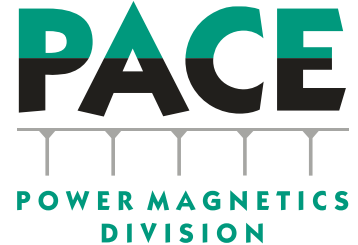

Dimensions

A	B	C	D	E	F
42.0 +1.3 -0.7	42.4 + 0.4 -0.8	15±0.5	29.5 + 1.7 -0	12.2 + 0 -0.5	29.6 + 1.4 -0

power loss as a function of flux density and frequency
16kHz 200mt = 80m w/cc at temperature 25-80°C

Standard Characteristics of Material

Material		Tanσ / μiau (x10 ⁻⁵) 10KHz	αμr (x10 ⁻⁶)	TC (°C)	f (MHz)
SB7C	2400 ±20%	0.2	-0.5	200	<0.3

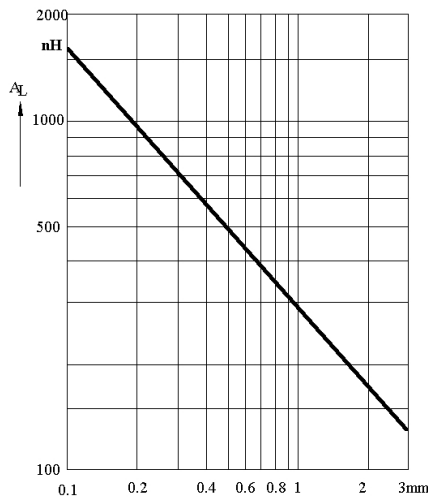

Typical AL (nH/cm²) as a function of centre pole air gap

Accessories for EE42 x 15 cores Bobbin 12 pin PCB mounting

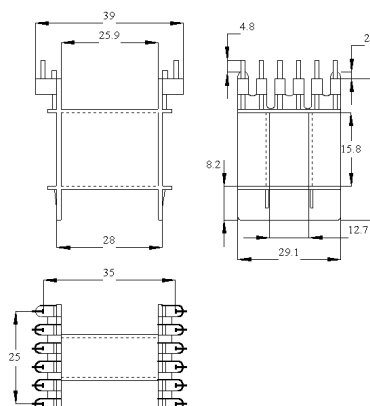

TYPE 01390

CLAMPS: STAINLESS STEEL (2 PER ASSEMBLY REQD)

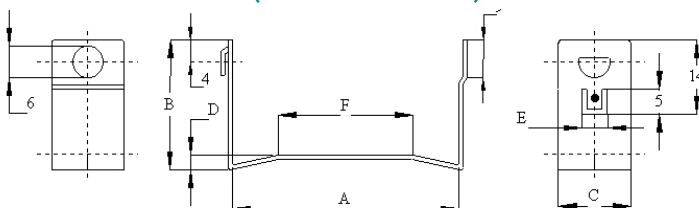

TYPE	CODE	A	B	C	D	E	F
FK- E 42	78951	42.4	25.6	14.0	2.5	4.5	27

Bobbin moulded from glass loaded Polyamid 6.6 conforms to UL 94 HB
Temperature rating -60 to +120°C for 2 secs. Maximum soldering temperature
+350°C for 2 seconds

Power Magnetics

10 Balmer Cut,
Buckingham Industrial Park,
Buckingham MK18 1UL

T 01280 817243

F 01280 823167

E sales@powermagnetics.co.uk
www.powermagnetics.co.uk

